

Recommended Panel Cutout

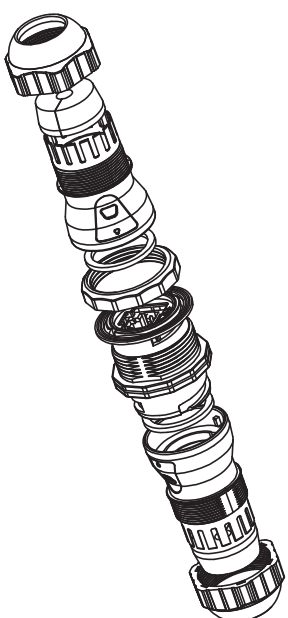
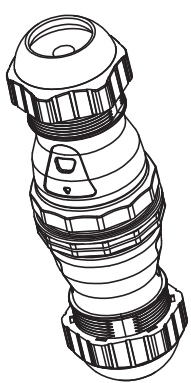
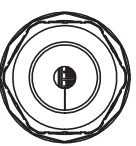
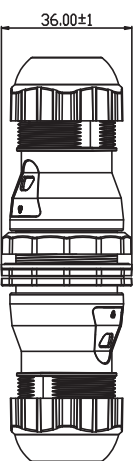
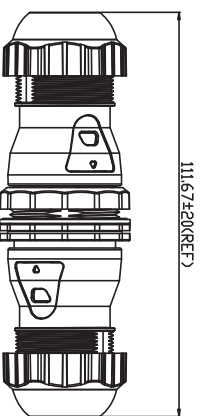
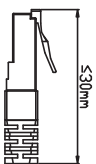

ELECTRICAL:
Current rating : 1.5A
Dielectric withstanding voltage : 1000V/A/C 60Hz
Insulation resistance : 500 MΩ MIN.
Contact resistance : 20 mΩ MAX.

MECHANICAL:
Supporting Cable Diameter: 4~6mm
Operating Temperature:-10°C to +60°C
Storage Temperature:-40°C to +70°C
MEETS IP68 STANDARD

MATERIAL:
Housing: PA66
Seal Ring: SILICONE RUBBER
RJ45 Coupler:
Housing: Zinc-alloy ,Nickel Plated
Contact:Phosphor bronze, 50u" Gold Plating



Title: Cable Connector RJ45 jack to RJ45 Jack
Cat.6A IP68 dust and waterproof

Dat	2024 / 05 / 21	Item no.	67044
Unit	mm	Barcode	4043619670444
Projection		File No.	88467
Rev	A		