

Delock External Enclosure for M.2 NVMe PCIe SSD or SATA SSD with USB 10 Gbps Type-A male

Description

This enclosure by Delock enables the installation of an **M.2 PCIe NVMe SSD** or **SATA M.2 SSD** in 2280, 2260, 2242 and 2230 format. It can be connected via USB to the PC or laptop. The **robust metal housing** ensures an **optimum temperature of the memory**.

Combo enclosure

The big advantage of this Delock M.2 enclosure is that both SATA and PCIe (NVMe) M.2 SSDs can be inserted into the enclosure. The memory is **automatically recognized by the chipset** and can then be used.

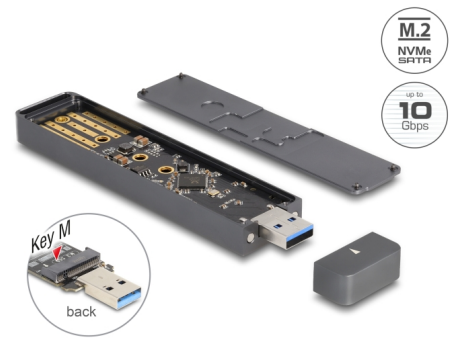

Item no. 42021

EAN: 4043619420216

Country of origin: China

Package: Retail Box

Technical details

- Connectors:
external: 1 x USB 10 Gbps Type-A male
internal: 1 x M.2 key M slot
- Chipset: Realtek RTL9210B
- Supports M.2 modules in format 2280, 2260, 2242 and 2230 with key M or key B+M based on SATA or PCIe (NVMe)
- Maximum height of the components on the module: 1.5 mm, application of double-sided assembled modules supported
- Supports NVM Express (NVMe)
- Bootable
- Data transfer rate up to 10 Gbps
- Metal housing
- Dimensions (LxWxH): ca. 121 x 26 x 10 mm
- Hot Plug, Plug & Play

System requirements

- Android 11.0 or above
- Chrome OS
- Linux Kernel 5.15 or above
- Mac OS 12.4 or above
- Windows 8.1/8.1-64/10/10-64/11
- PC or laptop with a free USB Type-A port

Package content

- External enclosure M.2
- Mounting material
- Screwdriver
- 1 x thermal conductive pad
- Key chain
- User manual

Images



General

Function:	bootable
Supported operating system:	Chrome OS Windows 10 32-Bit Windows 10 64-Bit Windows 8.1 32-Bit Windows 8.1 64-Bit Windows 11 Mac OS 12.4 oder höher Android 11.0 or above Linux Kernel 5.15 or above
Supported module:	M.2 modules in format 2280, 2260, 2242 and 2230 with key M or key B+M based on SATA or PCIe
Maximum height of the components on the module:	1.5 mm application of double-sided assembled modules supported

Interface

External:	1 x USB 10 Gbps Type-A male
Internal:	1 x M.2 key M slot

Technical characteristics

Chipset:	Realtek RTL9210B
Data transfer rate:	10 Gbps

Physical characteristics

Housing material:	Aluminium
Length:	121 mm
Width:	26 mm
Height:	10 mm
Colour:	grey