

Delock M.2 Docking Station for 2 x M.2 NVMe PCIe SSD with Clone function

Description

This M.2 docking station by Delock enables the installation of **two M.2 PCIe NVMe SSDs** and it can be connected via USB to the PC or laptop. The included USB cable allows the connection to a free USB-C™ port.

M.2 PCIe SSD clone function

The clone function enables to **copy the content of one SSD to another** without using a PC.

Ideal test equipment

The memory is simply plugged into the robust housing and can be used immediately. No screws, tools or accessories are required, which means that the SSD can be changed quickly.

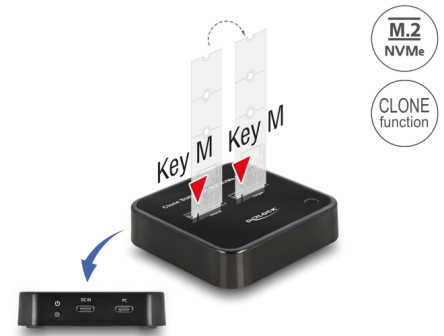

Item no. 64177

EAN: 4043619641772

Country of origin: China

Package: Retail Box

Technical details

- Connectors:
 - 1 x USB 10 Gbps USB Type-C™ female
 - 2 x M.2 key M slot
 - 1 x USB Type-C™ female (power supply)
- Chipset: Asmedia ASM2362
- Supports M.2 modules with key M or key B+M based on PCIe (NVMe)
- Supports NVMe Express (NVMe)
- Data transfer rate up to 10 Gbps
- Supports UASP
- LED indicator for power, access and copy status
- Function key:
 - 1 x Clone button
 - 1 x On / Off switch
- Bootable
- Dimensions (LxWxH): ca. 72 x 79 x 18 mm
- Hot Plug, Plug & Play

Power supply specification

- Wall power supply
- Input: AC 100 ~ 240 V / 50 ~ 60 Hz / 0.6 A
- Output: 5.0 V / 3.0 A

System requirements

- Android 10.0 or above
- Chrome OS 83.0 or above
- Linux Kernel 5.4 or above
- Mac OS 10.15.6 or above
- Windows 8.1/8.1-64/10/10-64/11
- Device with a free USB Type-C™ port or with a free Thunderbolt™ 3 port

Package content

- M.2 docking station
- Cable USB-C™ male to USB-C™ male, length ca. 45 cm
- Cable USB-C™ male to USB Type-A male, length ca. 80 cm (power supply)
- External power supply
- User manual

Images



General

Function:	Clone Function
Supported operating system:	Chrome OS 83.0 or above Linux Kernel 5.4 or above Mac OS 10.15.6 or above Windows 10 32-Bit Windows 10 64-Bit Windows 8.1 32-Bit Windows 8.1 64-Bit Android 10.0 or above
Slot:	PCIe
Maximum height of the components on the module:	1.5 mm application of double-sided assembled modules supported

Interface

Connector 1:	1 x USB 10 Gbps USB Type-C™ female
Connector 2:	2 x 67 pin M.2 key M slot
connector 3:	1 x USB Type-C™ female (power supply)

Technical characteristics

Data transfer rate:	10 Gbps
---------------------	---------

Physical characteristics

Length:	79 mm
Width:	72 mm
Height:	18 mm
Colour:	black