

Delock WLAN 802.11 ac/ax/a/h/b/g/n Antenna I-PEX Inc., MHF® 4L plug 1.6 dBi 25 cm PIFA internal

Description

This antenna by Delock allows the usage of the 2.4 GHz + 5 GHz WLAN bands indoors.

PIFA antennas (**P**lanar **I**nverted **F**-Shaped **A**ntenna) are particularly very flat antennas that can be integrated directly on the PCB.

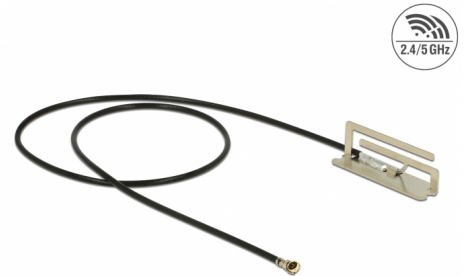

25 cm

Item no. 86217

EAN: 4043619862177

Country of origin: Taiwan, Republic of China

Package: Zip poly bag

Technical details

- Connector: 1 x I-PEX Inc., MHF® 4L plug
- Frequency range:
 - 2400 - 2500 MHz
 - 5150 - 5850 MHz
- Bluetooth, WLAN 2.4 / 5.0 GHz, ZigBee 2.4 GHz, ISM
- Antenna gain: 1.6 dBi
- VSWR: 2.5
- Impedance: 50 Ohm
- Operating temperature: -10 °C ~ 55 °C
- Colour: black
- Cable type: coaxial
- Cable type: 1.13
- Cable colour: black
- Cable diameter: ca. 1.13 mm
- Cable attenuation: 3.2 dB @ 2.4 GHz per meter
- Smallest bending radius: 4.5 mm
- Dimensions (LxWxH): ca. 21.5 x 7.0 x 6.0 mm
- Length incl. connectors (L): ca. 25 cm

System requirements

- Device with one free I-PEX Inc., MHF® 4L port

Package content

- Antenna

Images

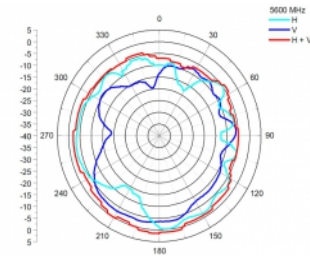
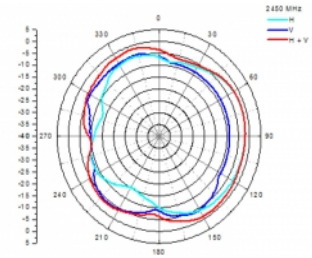
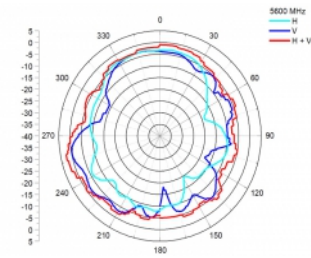
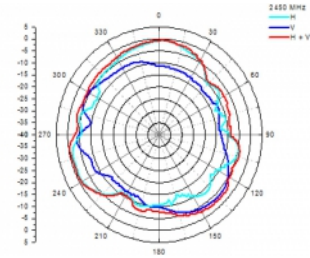
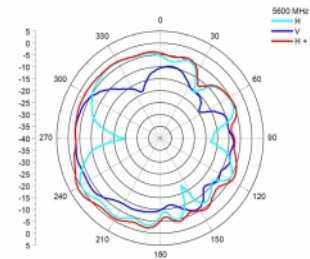
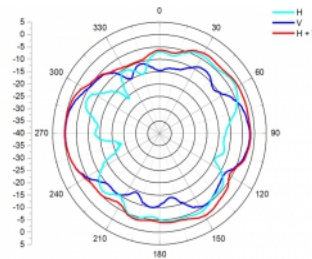
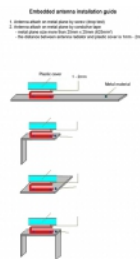
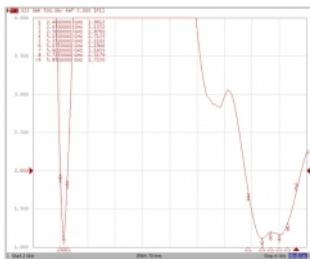

General

Suitable for indoor:	yes
----------------------	-----

Interface

connector:	1 x I-PEX Inc., MHF® 4L plug
------------	------------------------------

Technical characteristics

Frequency range:	5150 MHz - 5875 MHz 2400 MHz - 2500 MHz
Antenna gain:	1.6 dBi
Impedance:	50 Ω
Operating temperature:	-10 °C ~ 55 °C
VSWR:	2.5

Physical characteristics

Antenna type:	PIFA
Cable category:	coaxial
Cable type:	1.13
Cable attenuation:	3.2 dB @ 2.4 GHz per meter
Cable colour:	black
Cable length incl. connector:	25 cm
Length:	21.5 mm
Width:	7.0 mm
Height:	6.0 mm
Smallest bending radius:	4.5 mm