

Delock PCI Express x1 Card to 4 x Serial RS-232 High Speed 921K with Voltage supply

Description

The Delock PCI Express card expands your system by four High Speed RS-232 ports. Use this card for applications like data logging, machine control systems, automation, development or communication. By the extensive surge protection and the wide temperature range this card can be used in the industrial area. Connected devices can be supplied with voltage of 5 V or 12 V optionally.

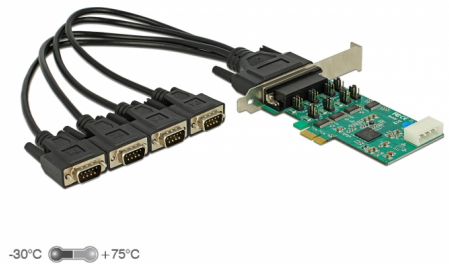

Item no. 89335

EAN: 4043619893355

Country of origin: Taiwan,
Republic of China

Package: Box

Technical details

- Chipset: Exar 17V354
- Connector:
 - external:
 - 1 x D-Sub 44 Pin female
 - connecting cable: D-Sub 44 pin male > 4 x Serial RS-232
 - D-Sub 9 pin male
 - internal:
 - 1 x PCI Express x1, V2.0
 - 1 x 4 pin Molex power connector
- Baud rate: up to 921.6 Kb/s
- Compatible to 16C550 UART
- FIFO 256 Byte
- Data bit: 5, 6, 7, 8
- Stop bit: 1, 1.5, 2
- Parity: None, Even, Odd, Space, Mark
- Flow Control: RTS / CTS, XON / XOFF
- 5 V or 12 V can be set individually for each port through the jumper (pin 1 or 9)
- Operating temperature: -30 °C ~ +75 °C

- Storage temperature: -40 °C ~ +85 °C
- Ambient relative humidity max. 95 % (non-condensing)
- 15 kV ESD protection for all signals
- I/O address and IRQ assigned by the system

System requirements

- Windows XP/XP-64/Vista/Vista-64/7/7-64/8.1/8.1-64/10/10-64/11, Linux ex Kernel 2.6
- PC with a free PCI Express slot
- Power supply with a free Molex power connector

Package content

- PCI Express card
- Low profile bracket
- 1 serial connecting cable (ca. 30 cm)
- Driver CD
- User manual

Images

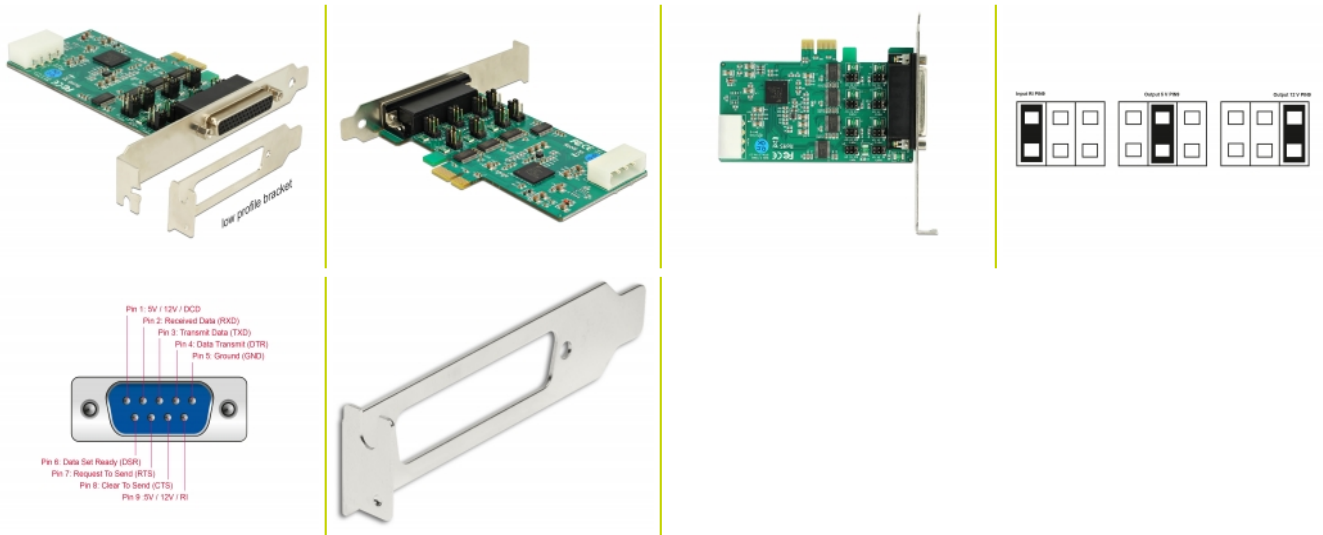

General

Form factor:	Low Profile
Function:	Plug & Play Power over Serial
Specification:	RS-232 (EIA / TIA) PCI Express 2.0
Supported operating system:	Windows 10 32-Bit Windows 10 64-Bit Windows 7 32-Bit Windows 7 64-Bit Windows 8 32-bit Windows 8 64-bit Windows 8.1 32-Bit Windows 8.1 64-Bit Windows Vista 32-bit Windows Vista 64-bit Windows XP 32-bit Windows XP 64-bit
Slot:	PCIe

Interface

External:	1 x Serial RS-232 DB9 plug
Internal:	1 x PCI Express x1, V2.0

Technical characteristics

Chipset:	Exar 17V354
Data transfer rate:	4 x up to 921,6 Kbps
FIFO:	4 x 256 Byte
Jumper:	8 x
Operating temperature:	-30 °C ~ 75 °C
Maximum current:	5V/500 mA per port 12V/500 mA per port

Voltage:	5 V or 12 V can be set individually for each port through the jumper (pin 1 or 9)
UART:	16C550