

Delock PCI Express x1 Card to 16 x Serial RS-232 High Speed ESD protection

Description

The PCI Express card by Delock expands the PC by **16 High Speed RS-232 ports**. These 16 ports are led out from the card by two **Fan-Out Cables**. Via the RS-232 ports, devices such as printers, cash register systems, measuring instruments, machines etc. can be connected.

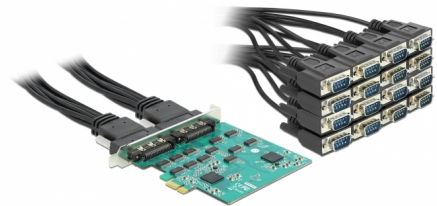

-30°C  +75°C

With the help of the **Plug and Play** support, the PCI Express card is installed by the operating system and the connected devices are automatically recognized. The **ESD Overvoltage Protection** and an **Extended Temperature Range** complete this card, which thus represents a reliable solution for many RS-232 devices.

Item no. 90501

EAN: 4043619905010

Country of origin: Taiwan, Republic of China

Package: Retail Box

High Speed RS-232 Ports

The data rate per port is up to 921.6 Kbps.

Fan-Out Cable

The fan-out cables with VHDCI connector to D-Sub9 connector allow maximum flexibility at the RS-232 ports.

ESD Overvoltage Protection

The protection against electrostatic discharge (ESD) is up to 15 kV.

Extended Temperature Range

Only very high-quality components with extended operating temperature range are used on the PCI Express card.

Technical details

- Connectors:
 - external:
 - 2 x VHDCI 68 female
 - connecting cable: VHDCI 68 male > 8 x serial RS-232 DB9 male
 - internal:

- 1 x PCI Express x1, V1.1
- Chipset: MaxLinear XR17V358
- Compatible with 16C550 UART
- Data transfer rate up to 921.6 Kbps
- FIFO: 16 x 256 byte
- Databits: 5, 6, 7, 8
- Stop bits: 1, 1.5, 2
- Parity: even, odd, none, mark, space
- Flow control: none, hardware RTS / CTS, software XON / XOFF
- ±15 kV ESD protection for all serial signals
- Operating temperature: -30 °C ~ 75 °C
- Relative humidity: 0 - 95 % (non condensing)
- Cable length incl. connectors: ca. 40 cm
- Dimensions (LxW): ca. 100.0 x 102.5 mm

System requirements

- Windows 8.1/8.1-64/10/10-64/11
- PC with one free PCI Express slot

Package content

- PCI Express card
- 2 serial connecting cable
- Driver CD
- User manual

Images

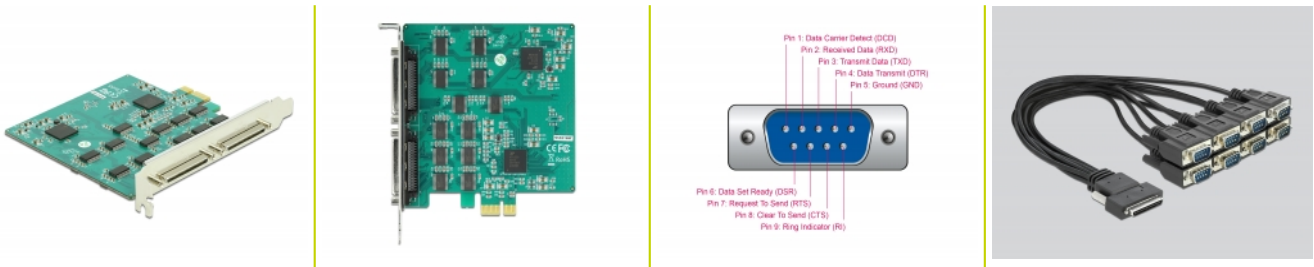

General

Function:	Plug & Play
Specification:	RS-232 (EIA / TIA) PCIe 1.1
Supported operating system:	Windows 10 32-Bit Windows 10 64-Bit Windows 8.1 32-Bit Windows 8.1 64-Bit Windows 11
Slot:	PCIe
Protection:	ESD (Electrostatic Discharge)

Interface

External:	8 x serial RS-232 DB9 Plug 2 x VHDCI-68 female
Internal:	1 x PCI Express x1, V1.1

Technical characteristics

Chipset:	Maxlinear XR17V358 SP3243EUEA
Data transfer rate:	75, 110, 134, 150, 300, 600, 1200, 1800, 2400, 4800, 7200, 9600, 10000, 14400, 19200, 25000, 38400, 50000, 57600, 100000, 115200, 128000, 200000, 230400, 250000, 460800, 500000, 921600 and more
FIFO:	16 x 256 Byte
Operating temperature:	-30 °C ~ 75 °C
Humidity:	0 ~ 95 %
Signal transmission:	TxD, RxD, RTS, CTS, DTR, DSR, DCD, RI, GND
Data transmission:	asynchronous Bi-directional full duplex
UART:	16C550

Data bits:	5, 6, 7, 8
------------	------------

Physical characteristics

Cable colour:	black
Cable length incl. connector:	40 cm
Screw type:	#4-40 UNC
Length:	100 mm
Width:	102.5 mm
Colour:	green